



# BIM Helper Tools manuals

Licenses	Settings	Manuals	Batch print	Parameters	Subcategories	Export library	Browse families	Select/manage/import/export	Configure sheet	Multi sheets	Duplicate sheets	Relocate tags	Room tags
Software configuration			General tools			Libraries		Elements data	Sheet manipulations			Tags	

## Room tags

Places all room tags in the middle of the rooms.



Imagine you just created a bunch of rooms in Revit, by clicking somewhere in the floor plan. The room tags will be created on the location where you clicked.

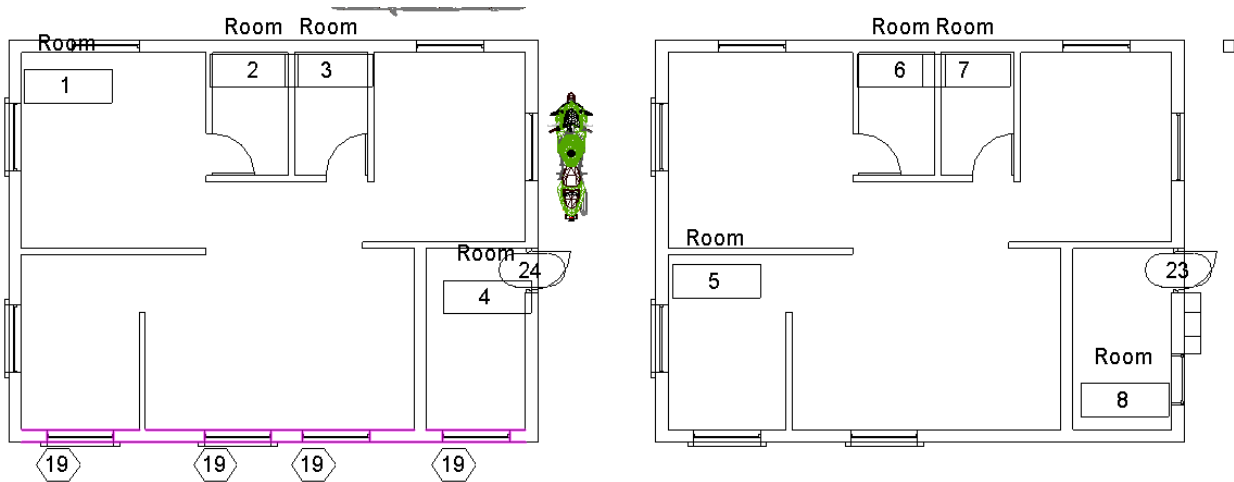

But that is not what you want. You want them to be in the middle of the room. Click the command 'Room tags' and you will see the tags move to the middle of the bounding box of the room.

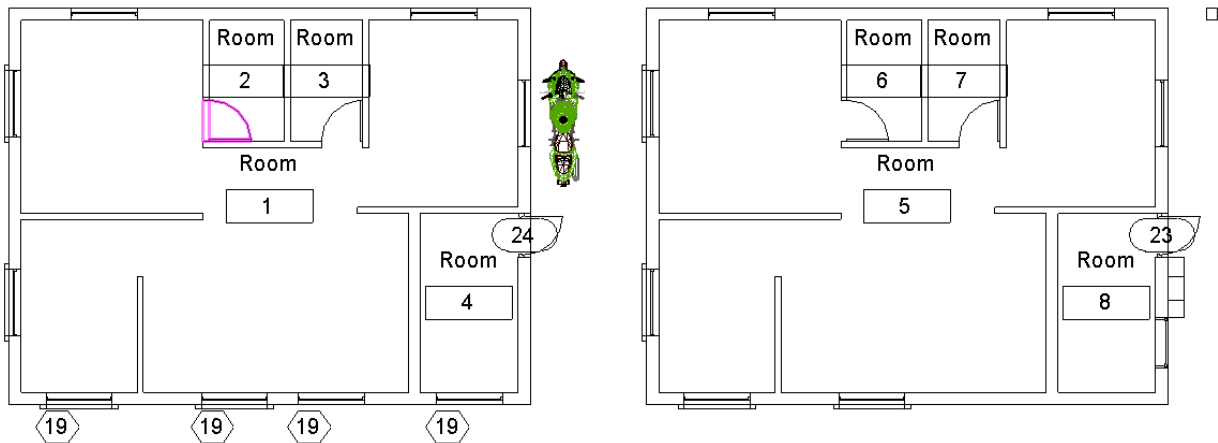

If a room is not rectangular, there is a chance that the tag would be outside the room. In this case, it will maintain the original position.